

#1837

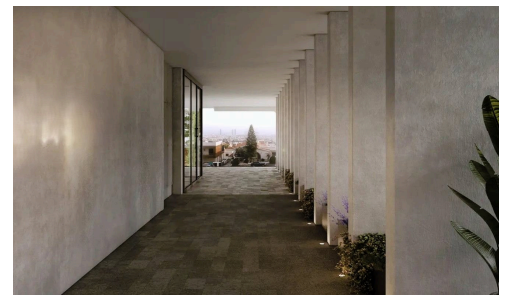
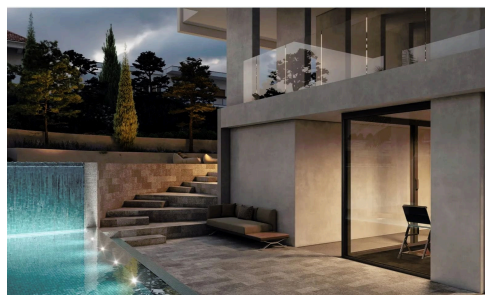
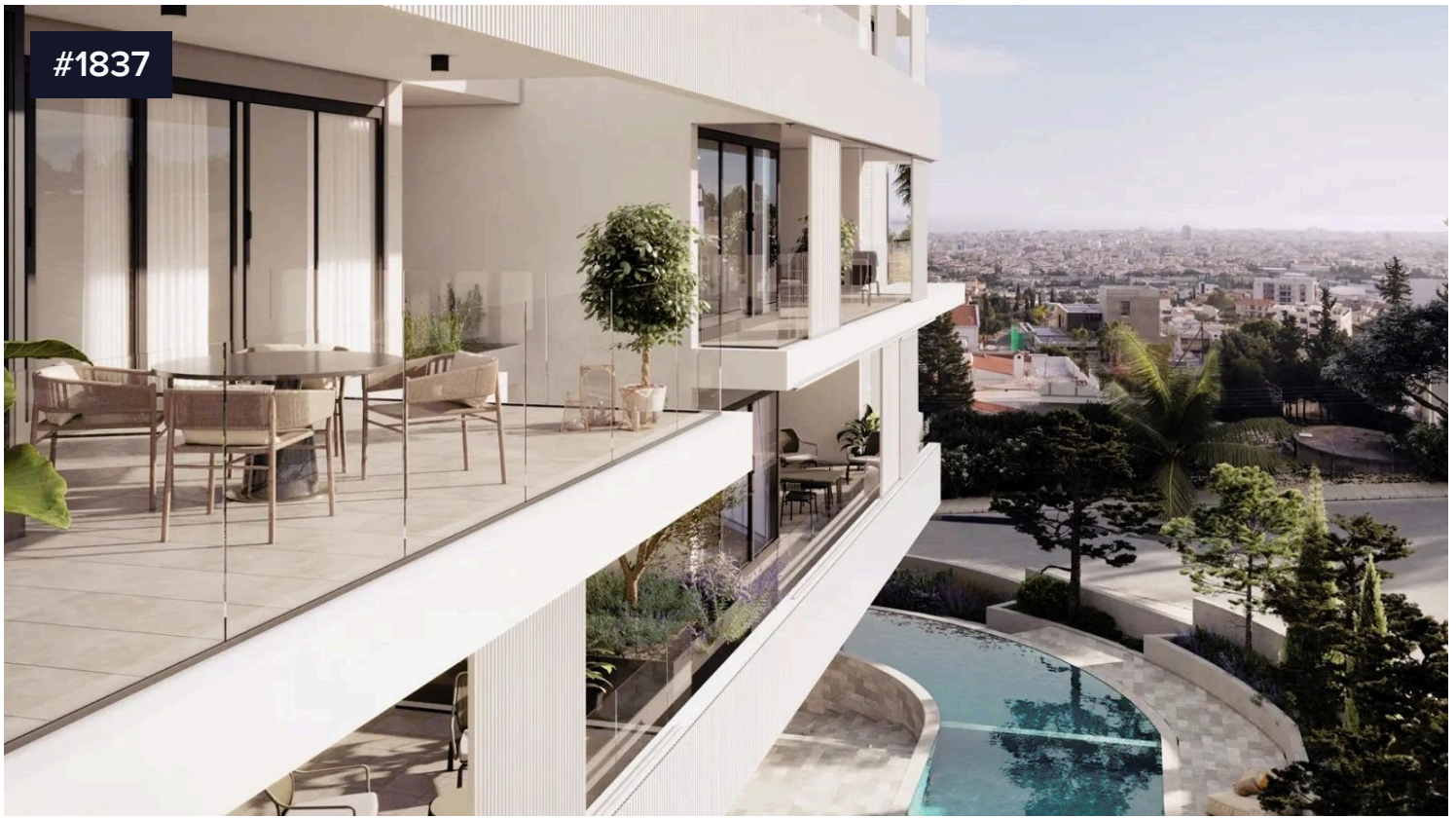

Modern 3 Bedroom Apartment With Communal Swimming Pool and Photovoltaic System 5kWp

€665,000 ^{+VAT}

 Panthea, Limassol

A newly designed project will be located in one of Limassol's prime locations, Panthea. The building's contemporary design and elegant layout will add beauty to the neighborhood. The building will accommodate luxurious two- and three-bedroom apartments with limitless natural light and unforgettable views of Limassol's coastline and city. A fully equipped gym and a communal swimming pool will add comfort and luxury to all residents.

Bedrooms

 3

Bathrooms

 3

Covered

 119 m²

Energy efficiency rating

 A

Top Stay Homes



Marios Georgiou

 (+357) 99342265

 marios@topstayhomes.com

